



OPTIMISED PAINT SYSTEM

Flexible Paint Cups & Accessories



Product Information

| Flexible Paint Cups | Code | Qty. |
|----------------------------------|---------------|---------|
| 125 micron filter 300ml | PSC301 | 45 sets |
| 190 micron filter 300ml | PSC306 | 45 sets |
| 125 micron filter 600ml | PSC601 | 45 sets |
| 190 micron filter 600ml | PSC606 | 45 sets |
| Accessories | | |
| Stoppers | PSS001 | 100 |
| Rigid Clear Cups 650ml - printed | PSM601 | 200 |
| Rigid Clear Cups 650ml - blank | PSM606 | 200 |

Product Description

Farécla's Optimised Paint System is an innovative process for the preparation and application of both solvent and water based paints.

Thanks to its robust 2-piece design, paint can be mixed directly in the cup, quickly assembled, used, re-filled and disposed of which guarantees a cost effective job.

Key Benefits

- Easy to use, store and re-use
- With only 2 pieces to assemble (instead of up to 4), the paint process is speeded up
- With no outer cup required, visibility of the paint remaining in the cup is increased
- Robust gun to cup connection - no chance of breaking
- The closed system means no leaks and allows for inverted spraying in hard to reach areas
- Inverted storage of mixed basecoat prevents the filter from drying out and needing to be replaced. Easy to write on the base of the inverted cup
- Blank Rigid Clear Cups are available for "over the scales" mixing reducing the chance of erroneous mixes
- Reduces costs, and time
- Rigid clear cup stays in the mixing area, reducing the risk of dust contamination in the spray booth
- Disposable system means time saved on cleaning and cost savings on solvents
- Lightweight and low wastage
- Reduces painter fatigue and increases productivity due to a lightweight design
- Whole cup collapses down during use leaving minimum waste disposal



How to Use

USE

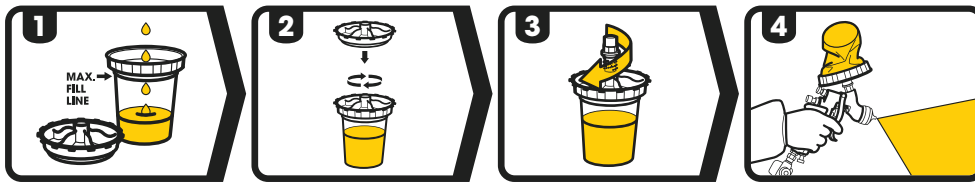

CAUTION



STORE



Use With

| Adaptor | Product Code | Spray Gun |
|---|--------------|--|
| Adaptor Type A | PSA00A | Bernardo Eccenaro, Iwata (W-400, WR-400, LPA-94, VXL-949, LPH400), Max-Air, Pro-Tek, SATA (NR 92 HVLP, Jet B GR, Jet GR 92 B, Jet B, Jet B NR 95 HVLP, Jet B NR 92). |
| Adaptor Type B | PSA00B | Aerometal, Air Gunsa (AR3, AZ3-HTE, AZ30-HTE), Eminent (E13, AZ3 HVLP, AZ3 HET), Iwata (Supernova WS 400), Sagola (Lux). |
| Adaptor Type C | PSA00C | DeVilbiss (GTi, GTi Pro, PRi, GFP, GFV, GFHV-510, SRI Pro, GTi Pro Lite). |
| Adaptor Type D | PSA00D | Air Gunsa (AZ4 Serial 75 - primer), Walcom (Geo F/X 97, FX HVLP, Slim). |
| Adaptor Type E | PSA00E | Kremlin (M21G), SATA (KLC - HVLP/RP/P, MCB family, Jet RP, Jet RP Digital, Jet 2000 HVLP, LM 2000 B, NR 2000 Digital, Jet 90/S), Walcom Genesi. |
| Adaptor Type F | PSA00F | Sagola, Sagola Mini. |
| Adaptor Type G | PSA00G | SATA Minijet, Sagola Mini. |
| Adaptor Type H | PSA00H | Aircraft. |
| Adaptor Type L | PSA00L | Sagola (4400 Xtreme). |
| Adaptor Type Q (SATA QCC Adaptor - use with Type E) | PSA00Q | SATA (Jet 2000 +Type E, Jet 3000 +Type E, Jet 4000 +Type E, Jet 5000 +Type E). |
| Adaptor Type R | PSA00R | DeVilbiss (guns with guages). |
| Adaptor Type S | PSA00S | Iwata LPH 80 (SMART repair). |
| Adaptor Type T | PSA00T | DeVilbiss SRI (SMART repair). |



Search on YouTube for
Farécla Optimised Paint System